



ATH 500 MT, DN 160 ISO-K, remote, heated

ATH 500 MT, DN 160 ISO-K, Remote, Heated



Similar Image

ATH 500 MT, DN 160 ISO-K, remote, heated

- 5-axis magnetically levitated turbopump with drag stage for a pump speed of up to 550 l/s for N₂
- Connection flange DN 160 ISO-K
- Compact integrated drive electronics
- Installation in any orientation
- Remote, Heated
- CE marked and ROHS compliant

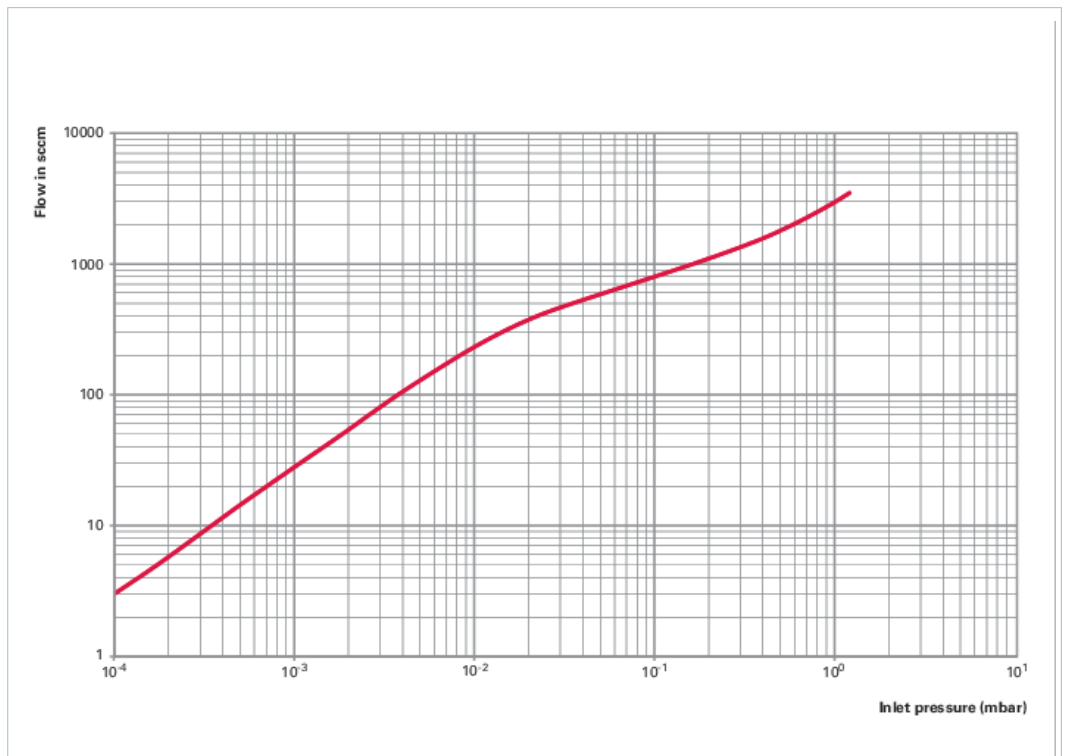
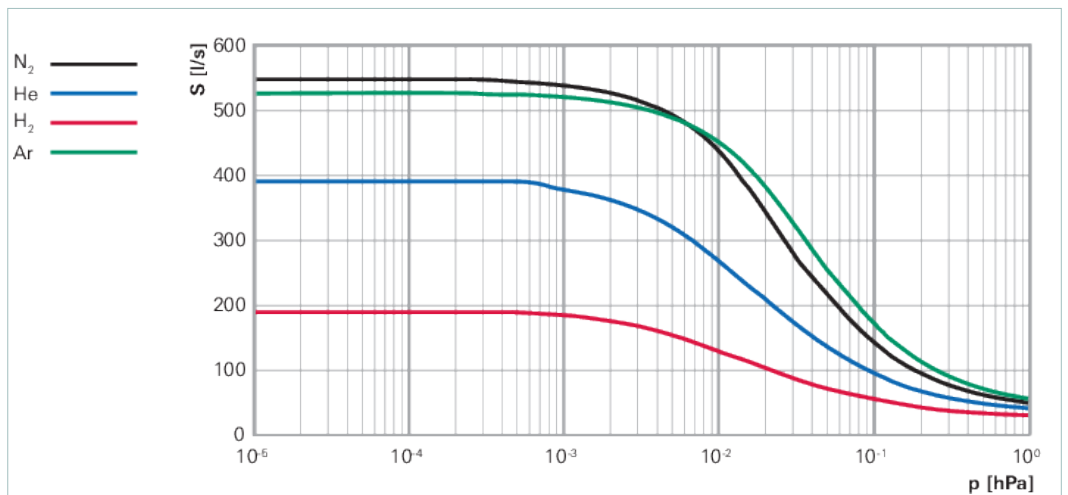

Dimensions

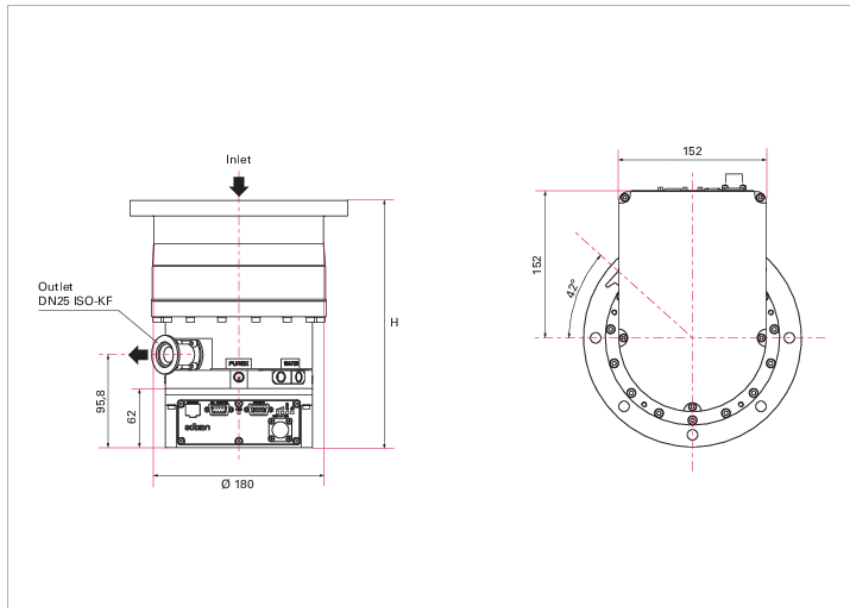

H 254.9 mm

Technical Data	ATH 500 MT, DN 160 ISO-K, remote, heated
Bearing	Magnet
Compression ratio for Ar	$> 8 \cdot 10^6$
Compression ratio for H ₂	$> 2 \cdot 10^2$
Compression ratio for He	$> 1 \cdot 10^4$
Compression ratio for N ₂	$> 2 \cdot 10^7$
Connection flange (in)	DN 160 ISO-K
Connection flange (out)	DN 40 ISO-KF
Cooling method	Water
Cooling water flow	60 l/h
Cooling water flow, max.	60 l/h
Cooling water flow, min.	60 l/h
Cooling water temperature	15-25 °C 59-77 °F 288-298 K
Corrosive gas version	Yes
Electronic drive unit	Integrated drive electronics
Final pressure	$< 1 \cdot 10^{-8}$ hPa $< 7.5 \cdot 10^{-9}$ Torr $< 1 \cdot 10^{-8}$ mbar
Final pressure without gas ballast	$< 1 \cdot 10^{-8}$ hPa $< 7.5 \cdot 10^{-9}$ Torr $< 1 \cdot 10^{-8}$ mbar
Fore-vacuum max. for N ₂	2.6 hPa 1.95 Torr 2.6 mbar
Gas throughput at maximum rotation speed for Ar, heated pump at 65 °C	5.1 hPa·l/s
Gas throughput at maximum rotation speed for H ₂ , heated pump at 65 °C	> 16.9 hPa·l/s
Gas throughput at maximum rotation speed for N ₂ , heated pump at 65 °C	8.5 hPa·l/s
Gas throughput for Ar	42.3 hPa·l/s
Gas throughput for H ₂	> 169 hPa·l/s
Gas throughput for He	> 169 hPa·l/s
Gas throughput for N ₂	67.6 hPa·l/s
I/O interfaces	Remote
Mounting orientation	Arbitrary
Operating voltage: V DC	48 (± 5 %) V DC
Particle intake	YES
Power consumption at final pressure	100 W
Power consumption max.	560 W
Pumping speed for Ar	530 l/s
Pumping speed for H ₂	190 l/s

Technical Data	ATH 500 MT, DN 160 ISO-K, remote, heated
Pumping speed for He	390 l/s
Pumping speed for N ₂	550 l/s
Rotation speed ± 2 %	50,000 rpm 50,000 min ⁻¹
Run-up time	< 2 min
Sound pressure level	≤42 dB(A)
Weight	18 kg 39.68 lb

Order number	
ATH 500 MT	VR412103

Accessories	
Cables Mains cables / Power cords	
Mains cable 2.0 m European standard 200–240 V AC 48 VDC power supply (for ATH 500M)	103566
Mains cable 2.0 m US standard 200–240 V AC 48 VDC power supply (for ATH 500M)	103898
Mains cable 3.5 m 48 V DC (for ATH 500 M)	A331328-035
Connections Connection kits for mounting of pumps	
Connection kit for mounting pumps, DN 40 ISO-KF	120SWS040-1000
Control Devices Power supplies and control displays	
Hand held remote (HHR) with cable	114461
External power supply pack for ATH 500 M/MT	114866
OmniControl 200 with PKR 361, 25 KF	PT 440 955 -T
Mounting Mounting kits for ATH-M <verteilen>	
Screw set for ISO-K (for ATH 500 M, DN 160)	117996
Protection Inlet screens	
Stainless inlet filter for DN 160	118002
Valves Isolation valves	
HV gate valve, DN 160 ISO-F, electro-pneumatic, PI (RS)/PV 24 V DC, SS/FKM	GVP-S10342
Valves Sealing gas valves, shielded (normally closed)	
Sealing plug for sealing gas connection with sealing ring (for ATH 500 M)	115298S
Venting Venting valves (normally closed)	
Air venting valve (for ATH 500 M)	200043

VACUUM SOLUTIONS FROM A SINGLE SOURCE

Pfeiffer Vacuum stands for innovative and custom vacuum solutions worldwide, technological perfection, competent advice and reliable service.

COMPLETE RANGE OF PRODUCTS

From a single component to complex systems:

We are the only supplier of vacuum technology that provides a complete product portfolio.

COMPETENCE IN THEORY AND PRACTICE

Benefit from our know-how and our portfolio of training opportunities!

We support you with your plant layout and provide first-class on-site service worldwide.

Are you looking for a
perfect vacuum solution?
Please contact us:

Pfeiffer Vacuum GmbH
Headquarters · Germany
T +49 6441 802-0
info@pfeiffer-vacuum.de

www.pfeiffer-vacuum.com

All data subject to change without prior notice.

PFEIFFER  **VACUUM**